

STATE OF ILLINOIS)
) SS
COUNTY OF KANE)

SECRETARY'S CERTIFICATE

I, , the duly qualified and acting Secretary of the Board of Trustees of Fox River and Countryside Fire Rescue District, Kane County, Illinois, do hereby certify that attached hereto is a true and correct copy of an Ordinance entitled:

ORDINANCE NO. 2020-06

**AN ORDINANCE DISCONNECTING CERTAIN TERRITORY
PURSUANT TO 70 ILCS 705/16d
(Kautz Road properties)**

which Ordinance was duly adopted by said Board of Trustees at a meeting held on the 17th day of August, 2020.

I do further certify that a quorum of said Board of Trustees was present at said meeting, and that the Board of Trustees complied with all the requirements of the Illinois Open Meetings Act.

IN WITNESS WHEREOF, I have hereunto set my hand this 17th day of August, 2020.

Secretary, Board of Trustees
Fox River and Countryside
Fire Rescue District

ORDINANCE NO. 2020-06

**AN ORDINANCE DISCONNECTING CERTAIN TERRITORY
PURSUANT TO 70 ILCS 705/16d
(Kautz Road properties)**

WHEREAS, the Fox River and Countryside Fire Rescue District, Kane County, Illinois (the "District") is a fire protection district duly organized under the laws of the State of Illinois; and

WHEREAS, the Board of Trustees (the "Board") of the District has full power to pass all necessary ordinances and rules for the proper management and conduct of District business pursuant to 70 ILCS 705/6; and

WHEREAS, the Board finds that the property identified in **Exhibit A** and depicted in **Exhibit B**, commonly identified as the Kautz Road properties, is currently within the Fox River and Countryside Fire Rescue District; and

WHEREAS, the property identified in **Exhibit A** consists of an area smaller than 60 acres; and

WHEREAS, 70 ILCS 705/16d allows the boards of trustees of two adjoining fire protection districts to transfer territory of no more than 60 acres by ordinance, upon agreement, after advance notice to the affected property owners [70 ILCS 705/16d]; and

WHEREAS, the Board has found that the territory identified in **Exhibit A** meets the qualifications set forth by 70 ILCS 705/16d to be disconnected from the District and annexed into the West Chicago Fire Protection District; and

WHEREAS, the Board has provided advance notice of the intended disconnection to each property owner as required by statute, with a copy of one such notice attached hereto as **EXHIBIT C**; and

WHEREAS, the Board finds good and ample cause exists to disconnect from the District by ordinance the property identified and legally described in the attached **EXHIBIT A**.

NOW, THEREFORE, BE IT ORDAINED by the Board of Trustees of the Fox River and Countryside Fire Rescue District, Kane County, Illinois as follows:

Section One: The Board of Trustees of the District hereby finds that the properties identified and legally described in **EXHIBIT A** attached hereto (the "Subject Properties") meet the qualifications of 70 ILCS 705/16d, in that:

- A. The territory consists of 60 acres or less; and
- B. The territory is adjacent to the West Chicago Fire Protection District but contained wholly within the Fox River and Countryside Fire Rescue District; and
- C. The West Chicago Fire Protection District is better equipped to provide the services to the subject property due to its location.

Section Two: The Board, after giving the property owners proper notice and an opportunity to be heard, hereby disconnects from the District the Subject Properties legally described in **EXHIBIT A**, effective January 1, 2021.

Section Three: The Fire Chief or designee is hereby authorized and directed to file a certified copy of this Ordinance with the Kane County Clerk and the State Fire Marshal, and to record this Ordinance with the Kane County Recorder.

Section Four: The provisions of this Ordinance shall be in full force and effect upon the adoption and signing of the Ordinance.

Section Five: This Ordinance shall supersede any ordinances, resolutions, motions, or parts of ordinances, resolutions, or motions in conflict with any part herein, and any such ordinance, resolution or motion or parts thereof, are hereby repealed to the extent of any conflict.

Section Six: If any section, paragraph or provision of this Ordinance shall be held invalid or unenforceable for any reason, such invalidity or inability to enforce any portion shall not affect any of the remaining provisions of this Ordinance.

ADOPTED this 17th day of August, 2020, by a roll call vote as follows:

AYES: Handley, Dunham, Karr, Wegman

NAYS: LeBlanc

ABSENT: φ

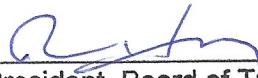

President, Board of Trustees
Fox River and Countryside
Fire Rescue District

ATTEST:



Secretary, Board of Trustees
Fox River and Countryside
Fire Rescue District

EXHIBIT A

Parcel 1

Address: 33W230 Toni Street, St. Charles, Illinois 60174

PIN: 09-36-426-004

LOT 38 OF COUNTYLINE SUBDIVISION, IN THE TOWNSHIP OF ST. CHARLES,
KANE COUNTY, ILLINOIS

Parcel 2

Address: 33W206 Toni Street, St. Charles, Illinois 60174

PIN: 09-36-426-005

LOT 37 OF COUNTYLINE SUBDIVISION, IN THE TOWNSHIP OF ST. CHARLES,
KANE COUNTY, ILLINOIS

Parcel 3

Address: 33W180 Toni Street, St. Charles, Illinois 60174

PIN: 09-36-426-006

LOT 36 OF COUNTYLINE SUBDIVISION, IN THE TOWNSHIP OF ST. CHARLES,
KANE COUNTY, ILLINOIS

Parcel 4

Address: 33W160 Toni Street, St. Charles, Illinois 60174

PIN: 09-36-426-007

LOT 35 OF COUNTYLINE SUBDIVISION, IN THE TOWNSHIP OF ST. CHARLES,
KANE COUNTY, ILLINOIS

Parcel 5

Address: 33W138 Toni Street, St. Charles, Illinois 60174

PIN: 09-36-426-008

LOT 34 OF COUNTYLINE SUBDIVISION, IN THE TOWNSHIP OF ST. CHARLES,
KANE COUNTY, ILLINOIS

Parcel 6

Address: 33W112 Toni Street, St. Charles, Illinois 60174

PIN: 09-36-426-009

LOT 33 OF COUNTYLINE SUBDIVISION, IN THE TOWNSHIP OF ST. CHARLES,
KANE COUNTY, ILLINOIS

Parcel 7

Address: 33W088 Toni Street, St. Charles, Illinois 60174
PIN: 09-36-426-010

LOT 32 OF COUNTYLINE SUBDIVISION OF PART OF THE EAST HALF OF THE SOUTHWEST QUARTER OF SECTION 36, TOWNSHIP 40 MORTH, RANGE 8, EAST OF THE THIRD PRINCIPAL MERIDIAN, KANE COUNTY, ILLINOIS AS SHOWN ON THE PLAT RECORDED JANUARY 13, 1961 BOOK OF PLATS 43, PAGE 16, DOCUMENT 938723, RECORDER'S OFFICE, KANE COUNTY, ILLINOIS

Parcel 8

Address: 33W062 Toni Street, St. Charles, Illinois 60174
PIN: 09-36-426-011

LOT 31 OF COUNTYLINE SUBDIVISION, IN THE TOWNSHIP OF ST. CHARLES, KANE COUNTY, ILLINOIS

Parcel 9

Address: 33W040 Toni Street, St. Charles, Illinois 60174
PIN: 09-36-426-012

LOT 30 IN COUNTYLINE SUBDIVISION OF PART OF THE EAST HALF OF THE SOUTHEAST QUARTER OF SECTION 36, TOWNSHIP 40 NORTH, RANGE 8, EAST OF THE THIRD PRINCIPAL MERIDIAN, KANE COUNTY, ILLINOIS, AS SHOWN ON PLAT RECORDED JANUARY 13, 1961, BOOK OF PLATS 43, PAGE 16, DOCUMENT NO. 938723, RECORDERS OFFICE, KANE COUNTY, ILLINOIS.

Parcel 10

Address: 33W022 Toni Street, St. Charles, Illinois, 60174
PIN: 09-36-426-013

LOT 29 OF COUNTYLINE SUBDIVISION, IN THE TOWNSHIP OF ST. CHARLES, KANE COUNTY, ILLINOIS.

Parcel 11

Address: 33W227 Toni Street, St. Charles, Illinois, 60174
PIN: 09-36-427-001

LOT 20 IN COUNTYLINE SUBDIVISION IN THE EASTERLY HALF OF SECTION 36, TOWNSHIP 40 NORTH, RANGE 8, EAST OF THE THIRD PRINCIPAL MERIDIAN, IN THE TOWNSHIP OF ST. CHARLES, KANE COUNTY, ILLINOIS, RECORDED JANUARY 13, 1961 AS DOCUMENT 938723

Parcel 12

Address: 33W207 Toni Street, St. Charles, Illinois 60174
PIN: 09-36-427-002

LOT 21 OF COUNTYLINE SUBDIVISION IN THE TOWNSHIP OF ST. CHARLES,
KANE COUNTY, ILLINOIS

Parcel 13

Address: 33W181 Toni Street, St. Charles, Illinois 60174
PIN: 09-36-427-003

LOT 22 AND THE WEST HALF OF LOT 23 IN COUNTYLINE SUBDIVISION, IN THE
TOWNSHIP OF ST. CHARLES, KANE COUNTY, ILLINOIS

Parcel 14

Address: 33W129 Toni Street, St. Charles, Illinois 60174
PIN: 09-36-427-004

THE EAST HALF OF LOT 23 AND ALL OF LOT 24 OF COUNTYLINE SUBDIVISION,
IN THE TOWNSHIP OF ST. CHARLES, KANE COUNTY, ILLINOIS

Parcel 15

Address: 2N273 Denny Drive, St. Charles, Illinois 60174
PIN: 09-36-428-001

LOT 25 IN COUNTYLINE SUBDIVISION OF PART OF THE EAST HALF OF THE
SOUTHEAST QUARTER OF SECTION 36, TOWNSHIP 40 NORTH, RANGE 8 EAST
OF THE THIRD PRINCIPAL MERIDIAN, KANE COUNTY, ILLINOIS, AS SHOWN ON
PLAT RECORDED JANUARY 13, 1961 BOOK OF PLATS 43, PAGE 16, DOCUMENT
NO. 938723, RECORDERS OFFICE, KANE COUNTY, ILLINOIS

Parcel 16

Address: 33W069 Toni Street, St. Charles, Illinois 60174
PIN: 09-36-428-002

LOT 26 OF COUNTYLINE SUBDIVISION, IN THE TOWNSHIP OF ST. CHARLES,
KANE COUNTY, ILLINOIS

Parcel 17

Address: 33W047 Toni Street, St. Charles, Illinois 60174
PIN: 09-36-428-010

LOT 27 OF COUNTYLINE SUBDIVISION IN THE TOWNSHIP OF ST. CHARLES, IN
KANE COUNTY, ILLINOIS.

Parcel 18

Address: 2N270 Kautz Road, St. Charles, Illinois 60174
PIN: 09-36-428-005

LOT 28 OF COUNTYLINE SUBDIVISION, IN THE TOWNSHIP OF ST. CHARLES,
KANE COUNTY, ILLINOIS

Parcel 19

Address: 33W228 Bonnie Street, St. Charles, Illinois 60174
PIN: 09-36-427-005

LOT 19 OF COUNTYLINE SUBDIVISION, IN THE TOWNSHIP OF ST. CHARLES,
KANE COUNTY, ILLINOIS

Parcel 20

Address: 33W208 Bonnie Street, St. Charles, Illinois 60174
PIN: 09-36-427-006

LOT 18 OF COUNTYLINE SUBDIVISION, IN THE TOWNSHIP OF ST. CHARLES,
KANE COUNTY, ILLINOIS

Parcel 21

Address: 33W170 Bonnie Street, St. Charles, Illinois 60174
PIN: 09-36-427-007

LOT 17 OF COUNTYLINE SUBDIVISION, IN THE TOWNSHIP OF ST. CHARLES,
KANE COUNTY, ILLINOIS

Parcel 22

Address: 33W160 Bonnie Street, St. Charles, Illinois 60174
PIN: 09-36-427-008

LOT 16 OF COUNTYLINE SUBDIVISION, IN THE TOWNSHIP OF ST. CHARLES,
KANE COUNTY, ILLINOIS

Parcel 23

Address: 33W136 Bonnie Street, St. Charles, Illinois 60174
PIN: 09-36-427-009

LOT 15 OF COUNTYLINE SUBDIVISION, IN THE TOWNSHIP OF ST. CHARLES,
KANE COUNTY, ILLINOIS

Parcel 24

Address: 33W116 Bonnie Street, St. Charles, Illinois 60174
PIN: 09-36-427-010

THE FOLLOWING DESCRIBED PROPERTY LOCATED IN THE COUNTY OF KANE, STATE OF ILLINOIS: LOT 14 IN THE COUNTYLINE SUBDIVISION OF PART OF THE EAST HALF OF THE SOUTHEAST QUARTER OF SECTION 36, TOWNSHIP 40 NORTH RANGE 8, EAST OF THE THIRD PRINCIPAL MERIDIAN, ACCORDING TO THE PLAT THEREOF RECORDED JANUARY 13, 1961 AS DOCUMENT NO. 938723, IN THE TOWNSHIP OF ST. CHARLES, KANE COUNTY, ILLINOIS

Parcel 25

Address: 02N241 Denny Drive, St. Charles, Illinois 60174
PIN: 09-36-428-006

LOT 13 OF COUNTYLINE SUBDIVISION, IN THE TOWNSHIP OF ST. CHARLES, KANE COUNTY, ILLINOIS

Parcels 26 & 27

Address: 33W046 Bonnie Street, St. Charles, Illinois 60174
PINS: 09-36-428-007; 09-36-428-008

LOT 12 IN COUNTYLINE SUBDIVISION OF PART OF THE EAST HALF OF THE SOUTHEAST QUARTER OF SECTION 36, TOWNSHIP 40 NORTH, RANGE 8 EAST OF THE THIRD PRINCIPAL MERIDIAN OF ST. CHARLES, KANE COUNTY, ILLINOIS

Parcel 28

Address: 33W020 Bonnie Street, St. Charles, Illinois 60174
PIN: 09-36-428-009

LOT 11 IN COUNTYLINE SUBDIVISION, BEING A SUBDIVISION OF PART OF THE EAST HALF OF THE SOUTHWEST QUARTER OF SECTION 36, TOWNSHIP 40 NORTH, RANGE 8, EAST OF THE THIRD PRINCIPAL MERIDIAN, ACCORDING TO THE PLAT THEREOF RECORDED JANUARY 13, 1961 AS DOCUMENT 938723, IN KANE COUNTY, ILLINOIS

Parcel 29

Address: 33W225 Bonnie Street, St. Charles, Illinois 60174
PIN: 09-36-476-001

LOT 1 OF COUNTYLINE SUBDIVISION, IN THE TOWNSHIP OF ST. CHARLES, KANE COUNTY, ILLINOIS

Parcel 30

Address: 33W205 Bonnie Street, St. Charles, Illinois 60174
PIN: 09-36-476-002

LOT 2 OF COUNTYLINE SUBDIVISION, IN THE TOWNSHIP OF ST. CHARLES, KANE COUNTY, ILLINOIS

Parcel 31

Address: 33W185 Bonnie Street, St. Charles, Illinois 60174
PIN: 09-36-476-003

LOT 3 OF COUNTYLINE SUBDIVISION IN THE TOWNSHIP OF ST. CHARLES, KANE COUNTY, ILLINOIS

Parcel 32

Address: 33W161 Bonnie Street, St. Charles, Illinois 60174
PIN: 09-36-476-004

LOT 4 OF COUNTYLINE SUBDIVISION, IN THE TOWNSHIP OF ST. CHARLES, KANE COUNTY, ILLINOIS

Parcel 33

Address: 33W135 Bonnie Street, St. Charles, Illinois 60174
PIN: 09-36-476-005

LOT 5 OF COUNTYLINE SUBDIVISION, IN TOWNSHIP OF ST. CHARLES, KANE COUNTY, ILLINOIS

Parcel 34

Address: 33W151 Bonnie Street, St. Charles, Illinois 60174
PIN: 09-36-476-006

LOT 6 OF COUNTYLINE SUBDIVISION, IN THE TOWNSHIP OF ST. CHARLES, KANE COUNTY, ILLINOIS

Parcel 35

Address: 33W091 Bonnie Street, St. Charles, Illinois 60174
PIN: 09-36-476-007

LOT 7 OF COUNTYLINE SUBDIVISION, IN THE TOWNSHIP OF ST. CHARLES, KANE COUNTY, ILLINOIS

Parcel 36

Address: 33W067 Bonnie Street, St. Charles, Illinois 60174
PIN: 09-36-476-008

SITUATED IN THE COUNTY OF KANE AND STATE OF ILLINOIS: LOT 8 OF COUNTYLINE SUBDIVISION IN THE TOWNSHIP OF ST. CHARLES, KANE COUNTY, ILLINOIS

Parcel 37

Address: 33W045 Bonnie Street, St. Charles, Illinois 60174
PIN: 09-36-476-009

LOT 9 IN COUNTY LINE SUBDIVISION, IN THE TOWNSHIP OF ST. CHARLES, KANE COUNTY, ILLINOIS

Parcel 38

Address: 33W021 Bonnie Street, St. Charles, Illinois 60174
PIN: 09-36-476-010

LOT 10 OF COUNTYLINE SUBDIVISION, IN THE TOWNSHIP OF ST. CHARLES, KANE COUNTY, ILLINOIS

Parcel 39

Address: 2N150 Kautz Road, St. Charles, Illinois 60174
PIN: 09-36-476-015

THE NORTH 10 ACRES OF THE SOUTH 30 ACRES (EXCEPT THE SOUTH 150 FEET OF THE EAST 462 FEET AND ALSO EXCEPT THE SOUTH 192.50 FEET OF THE WEST 320 FEET OF THE EAST 782 FEET, THEREOF) OF THE EAST HALF OF THE SOUTHEAST QUARTER OF SECTION 36, TOWNSHIP 40 NORTH, RANGE 8 EAST OF THE THIRD PRINCIPAL MERIDIAN, IN THE TOWNSHIP OF ST. CHARLES, KANE COUNTY, ILLINOIS

Parcel 40

Address: 02N152 Kautz Road, St. Charles, Illinois 60174
PIN: 09-36-476-016

THE SOUTH 150 FEET OF THE EAST 462 FEET AND THE SOUTH 192.5 FEET OF THE WEST 320 FEET OF THE EAST 782 FEET OF THE NORTH 10 ACRES OF THE SOUTH 30 ACRES OF THE EAST HALF OF THE SOUTHEAST QUARTER OF SECTION 36, TOWNSHIP 40 NORTH, RANGE 8 EAST OF THE THIRD PRINCIPAL MERIDIAN, IN THE TOWNSHIP OF ST. CHARLES, KANE COUNTY, ILLINOIS

Parcel 41

Address: 2N110 Kautz Road, St. Charles, Illinois, 60174
PIN: 09-36-476-012

THE NORTH 10 ACRES (EXCEPT THE SOUTH 125 FEET OF THE EAST 348.52 FEET) OF THE SOUTH 20 ACRES OF THE EAST HALF OF THE SOUTH EAST QUARTER OF SECTION 36, TOWNSHIP 40 NORTH, RANGE 8 EAST OF THE THIRD PRINCIPAL MERIDIAN, IN THE TOWNSHIP OF ST. CHARLES, KANE COUNTY, ILLINOIS

Parcel 42

Address: 2N098 Kautz Road, St. Charles, Illinois 60174
PIN: 09-36-476-013

THE SOUTH 125 FEET OF THE EAST 348.52 FEET OF THE NORTH 10 ACRES OF THE SOUTH 20 ACRES OF THE EAST HALF OF THE SOUTH EAST QUARTER OF SECTION 36, TOWNSHIP 40 NORTH, RANGE 8 EAST OF THE THIRD PRINCIPAL MERIDIAN, IN THE TOWNSHIP OF ST. CHARLES, KANE COUNTY, ILLINOIS

Parcel 43

Address: 2N020 Kautz Road, St. Charles, Illinois 60174
PIN: 09-36-476-014

THE SOUTH 10 ACRES OF THE EAST HALF OF THE SOUTHEAST QUARTER OF SECTION 36, TOWNSHIP 40 NORTH, RANGE 8 EAST OF THE THIRD PRINCIPAL MERIDIAN, IN THE TOWNSHIP OF ST. CHARLES, KANE COUNTY, ILLINOIS

EXHIBIT B

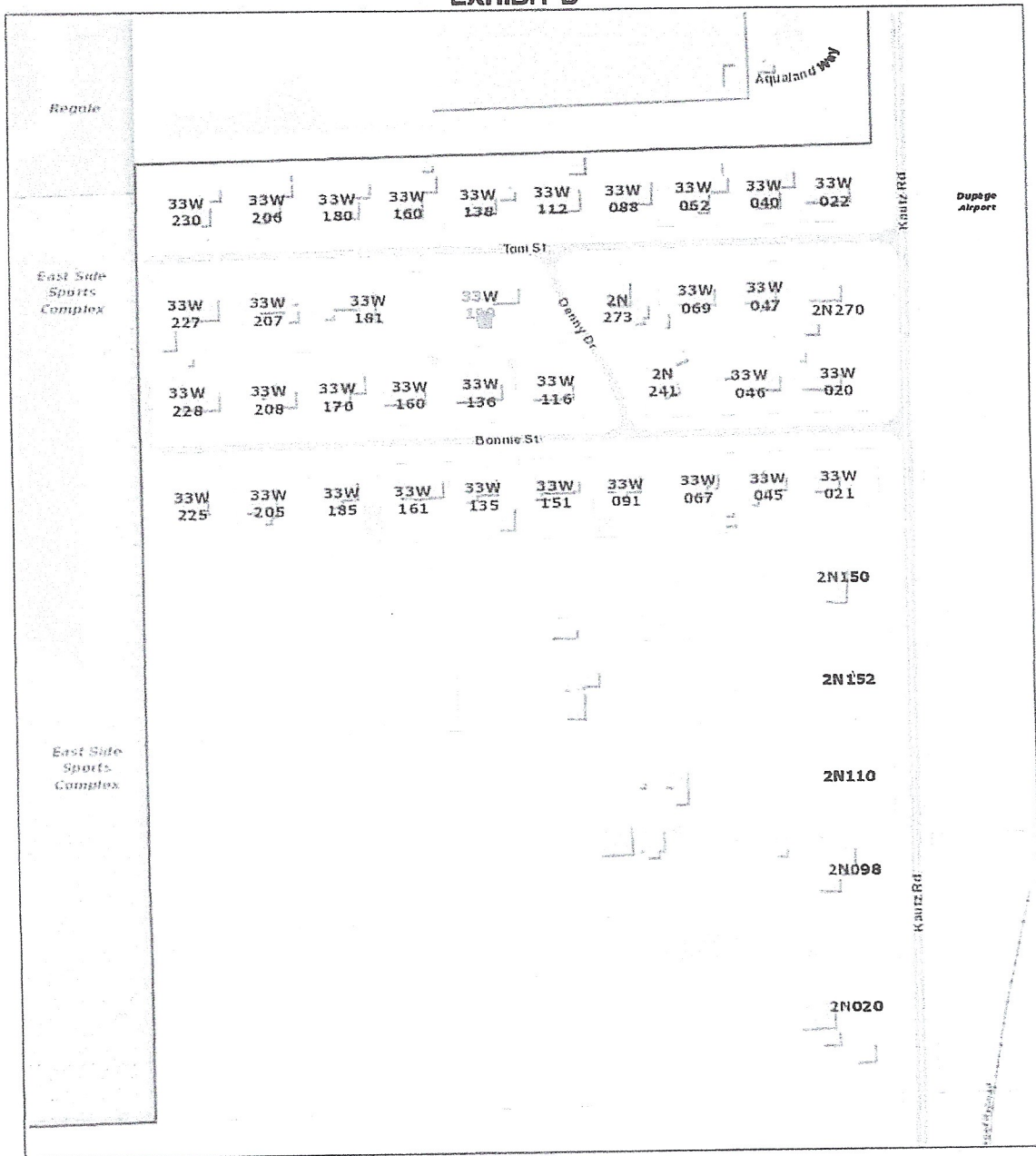

NOTICE OF PROPOSED ANNEXATION

NOTICE IS HEREBY GIVEN, pursuant to 70 ILCS 705/16d, that at 7:00 p.m. on August 17, 2020, a meeting will be held before the Board of Trustees of the Fox River and Countryside Fire Rescue District at 34w500 Carl Lee Road, St. Charles, Illinois, for the purpose of determining whether certain property, hereinafter referred to as the Kautz Road parcels, should be disconnected from the Fox River and Countryside Fire Rescue District and annexed into an adjoining district, the West Chicago Fire Protection District.

NOTICE IS ALSO GIVEN that at 7:00 p.m. on August 27, 2020, a meeting will be held before the Board of Trustees of the West Chicago Fire Protection District, 200 Fremont Street, West Chicago, Illinois, for the same purposes. Both meetings will allow for public comment and provide affected property owners with an opportunity to be heard. It is the intention of both Fire Protection Districts that ordinances be adopted at these meetings reflecting the disconnection from the Fox River and Countryside Fire Rescue District and annexation into the West Chicago Fire Protection District.

The territory sought to be disconnected from the Fox River and Countryside Fire Rescue District and annexed into the West Chicago Fire Protection District is an area of land of fewer than 60 acres in area. The territory sought to be transferred pursuant to 70 ILCS 705/16d, commonly known as the Kautz Road parcels, is legally described as follows with the corresponding Permanent Index Numbers:

That part of the East half of the Southwest Quarter of Section 36, Township 40 North, Range 8 East of the Third Principal Meridian, Kane County, Illinois, described in in Exhibit A.

The above legal description encompasses 43 parcels with the following Permanent Index Numbers: 09-36-426-004, 09-36-426-005, 09-36-426-006, 09-36-426-007, 09-36-426-008, 09-36-426-009, 09-36-426-010, 09-36-426-011, 09-36-426-012, 09-36-426-013, 09-36-427-001, 09-36-427-002, 09-36-427-003, 09-36-427-004, 09-36-428-001, 09-36-428-002, 09-36-428-010, 09-36-428-005, 09-36-427-006, 09-36-427-007, 09-36-427-008, 09-36-427-009, 09-36-427-010, 09-36-428-006, 09-36-428-007, 09-36-428-008, 09-36-428-009, 09-36-476-001, 09-36-476-002, 09-36-476-003, 09-36-476-004, 09-36-476-005, 09-36-476-006, 09-36-476-007, 09-36-476-008, 09-36-476-009, 09-36-476-010, 09-36-476-015, 09-36-476-016, 09-36-476-012, 09-36-476-013, 09-36-476-014

The transfer is proposed to provide better services to the Kautz Road parcels. The Kautz Road Parcels are also adjacent to the West Chicago Fire Protection District. The proposed transfer between fire protection districts shall not result in a disruption of services. The proposed effective date of the transfer between fire protection districts is January 1, 2021.

[Enclosed – legal descriptions of all parcels and map of affected area]

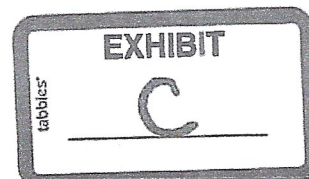

SERVICE LIST

PIN: 09-36-426-004

Alessandro & Tammy Ciotola
33w230 Toni St
Saint Charles, IL, 60174

PIN: 09-36-426-005

Debbie Gearen
33w206 Toni St
Saint Charles, IL, 60174

PIN: 09-36-426-006

Keith Mitchell
33w180 Toni St
Saint Charles, IL, 60174

PIN: 09-36-426-007

Brett Coletti
33w160 Toni St
Saint Charles, IL, 60174

PIN: 09-36-426-008

Jeffrey & Cynthia Babineau
33w138 Toni St
Saint Charles, IL, 60174

PIN: 09-36-426-009

Edwin & Mary Brummel
33w112 Toni St
St. Charles, IL, 60174

PIN: 09-36-426-010

Todd & Claudine Gamster
33w088 Toni St
St. Charles, IL, 60174

PIN: 09-36-426-011

William Parisi
33w062 Toni St
Saint Charles, IL, 60174

PIN: 09-36-426-012

Willie & Trista Grant
33w040 Toni St
Saint Charles, IL, 60174

PIN: 09-36-426-013

Jehan Nagarwalla
33w022 Toni St
Saint Charles, IL, 60174

PIN: 09-36-427-001

Angela Star Correa-Beltran,
Thomas Harris,
Linda Callaghan
33w227 Toni St
Saint Charles, IL, 60174

PIN: 09-36-427-002

Kimberly Hudon
33w207 Toni St
St. Charles, IL, 60174

PIN: 09-36-427-003

Juan Estrada
33w181 Toni St
Saint Charles, IL, 60174

PIN: 09-36-427-004

Roger Scheiblein
33w129 Toni St
Saint Charles, IL, 60174

PIN: 09-36-428-001

Curt & Marlene Springer
2n273 Denny Dr
St. Charles, IL, 60174

PIN: 09-36-428-002

Joshua & Rachel Lund
33w069 Toni St
Saint Charles, IL, 60174

PIN: 09-36-428-010

Jason & Jessica Denk
33w047 Toni St
Saint Charles, IL, 60174

PIN: 09-36-428-005

Christina M Thompson
2n270 Kautz Rd
Saint Charles, IL, 60174

PIN: 09-36-427-005

Kristin Paletta
33w228 Bonnie St
Saint Charles, IL, 601745307

SERVICE LIST

PIN: 09-36-427-006
Fay Andersen Lang
33w208 Bonnie St
Saint Charles, IL, 601745307

PIN: 09-36-427-007
Terry Lee & Ruth Ellen Armstrong
33w170 Bonnie St
St. Charles, IL, 60174

PIN: 09-36-427-008
Laurence & Christine Ganek
33w160 Bonnie St
St. Charles, IL, 60174

PIN: 09-36-427-009
Edward & Joan Kramer
33w136 Bonnie St
St. Charles, IL, 60174

PIN: 09-36-427-010
Andrew & Kimberly Coppert
33w116 Bonnie St
Saint Charles, IL, 60174

PIN: 09-36-428-006
Stephen Snively
02n241 Denny Dr
St. Charles, IL, 60174

PINS: 09-36-428-007 & 09-36-428-008
James & Diane Anderson
33w046 Bonnie St
St. Charles, IL, 60174

PIN: 09-36-428-009
Mark Ristau
33w020 Bonnie St
St. Charles, IL, 60174

PIN: 09-36-476-001
Michael & Mary Scheffler
33w225 Bonnie St
St. Charles, IL, 60174

PIN: 09-36-476-002
Leon & Enedina Lambert
33w205 Bonnie St
St. Charles, IL, 60174

PIN: 09-36-476-003
Marv & Sharon Farber
33w185 Bonnie St
Saint Charles, IL, 60174

PIN: 09-36-476-004
WILLIE & VIVIAN GRANT
33W161 BONNIE ST
ST. CHARLES, IL, 60174

PIN: 09-36-476-005
Tarek & Soona Farag
33w135 Bonnie St
St. Charles, IL, 60174

PIN: 09-36-476-006
Michael & Susan Miller
33w151 Bonnie St
Saint Charles, IL, 60174

PIN: 09-36-476-007
Chad Sanchez
33W091 Bonnie St.
Saint Charles, IL, 60174

PIN: 09-36-476-008
Robert Govea
33w067 Bonnie St
St. Charles, IL, 60174

PIN: 09-36-476-009
Kevin Besch & Mary Kay Johnson
33W045 Bonnie St.
St. Charles, IL, 60174

PIN: 09-36-476-010
Oscar Sosa
33W021 Bonnie St
Saint Charles, IL, 60174

PIN: 09-36-476-015
JDJ Number 2 Holdings, LLC
2n150 Kautz Rd
Saint Charles, IL, 60174

PIN: 09-36-476-016
Tracy & Brian Mclean
2n152 Kautz Rd
Saint Charles, IL, 601745357

SERVICE LIST

PIN: 09-36-476-012
Marc & Jennifer Bossert
81 Highgate Crse
Saint Charles, IL, 60174

PIN: 09-36-476-013
Christopher Platt
2n098 Kautz Rd
St. Charles, IL, 60174

PIN: 09-36-476-014
Gary Maywald
708 Illinois St
Geneva, IL, 60134